

## Product Information

### Materials Testing Machine 330 kN Z330RED with testControl II

CTA: 199929 200335



Z330E with hydraulic grips

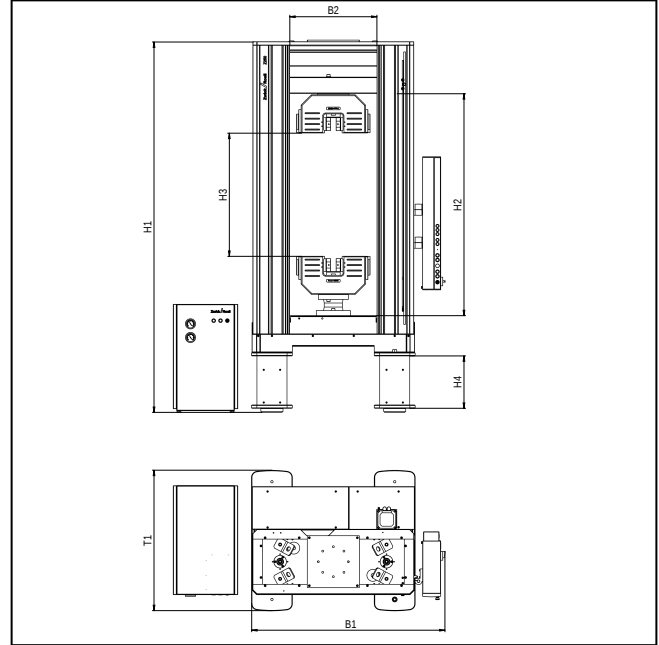

Drawing: Z330E with hydraulic grips

#### Advantages and features

##### Modern load-frame design

- The robust load-frame features four hard-chromed guide-columns and massive base and moving cross-heads, ensuring excellent guidance properties and a high level of machine stiffness.
- Maintenance-free digitally controlled AC drive technology combined with an innovative motor feedback system allows excellent constant speed characteristics to be achieved even at extremely low speeds.
- The backlash-free pre-stressed precision ball-screws with digitally controlled AC servo drive allow virtually maintenance-free operation.
- The large test area combined with low overall height enables specimens and components with a wide range of lengths to be tested.
- The testing machine is positioned directly on the ground with no foundation.

##### Operator convenience

- Convenient operating height for specimen insertion with grips installed.
- testXpert III's intelligent test environment concept reduces set-up times and increases productivity.

#### Innovative electronics

- The new testControl II measurement and control electronics provide the ideal basis for precise, reproducible test results.
- Developed in-house by ZwickRoell, the electronics impress through maximum accuracy, high measured-value rates and flexible modularity.

#### Future-proof

- Modular design means that the testing system can be re-equipped or upgraded whenever required.
- Moreover, testControl II control electronics are compatible with future-generation ZwickRoell software.
- Even after a product has been discontinued, spare parts remain available for a minimum of 10 years.

#### Satisfying the most demanding safety requirements

- Compliance with the statutory safety requirements of the EC Machinery Directive is ensured in all materials testing machines, while an EC Declaration of Conformity accompanies every machine supplied.
- Only the latest safety technology and proven industrial components are used.
- The highest degree of safety for the operator, test results, specimen material, and testing system are guaranteed.

## Product Information

### Materials Testing Machine 330 kN Z330RED with testControl II

Description	Value	
<b>Load frame</b>		
Paint finish	RAL 7021 black gray and RAL7038 agate gray	
Ambient temperature	+10 ... +35	°C
Humidity (non-condensing)	20 ... 90	%
<b>Drive</b>		
Motor	AC servo motor with concentrated windings, Hiperface® motor feedback system	
motor holding brake	yes	
Control, set-value specification	digital (real-time Ethernet, EtherCAT®)	
Controller/cycle time	adaptive / 1000	Hz
Repeat positioning accuracy on crosshead	± 1.0	µm
<b>Measurement and control electronics</b>		
Number of slots available for measurement and control module	5 synchronized module bus slots, 1 synchronized PCIe slot <sup>1)</sup>	
Force measurement	Class 0.5 from 1% of Fmax / Class 1 from 0.2 % of Fmax, as per EN ISO 7500-1, ASTM E4, JIS B 7721	
Calculated resolution (e.g. load cell in tensile/compression direction)	24	bit
Measured-value sampling-rate, internal	400	KHz
Measured-value transmission rate to PC	500 (optionally 2000)	Hz
Zero-point correction	automatic, at start of measurement	
Measurement signal runtime correction for all channels	yes	
Interface to PC	Ethernet	
Eco mode?	yes, power unit automatically switched off (time adjustable)	
CE compliance?	yes, as per Machinery Directive 2006/42EC	
<b>Electrical supply data</b>		
Mains supply frequency	50/60	Hz
Electrical supply	400 +/- 10 %	V, 3Ph, N, PE
Power consumption	5.5	kVA

1) A high-quality DCSC measurement module for one load cell is included in delivery (occupies one module bus slot).

## Options

Description	Item number
testControl II display-equipped remote control	<b>057984</b>
2,000 Hz measurement value transmission: Increasing the measurement value transmission from 500 Hz (standard) to 2000 Hz The measured values are transmitted to the testing software and processed in real time.	<b>057860</b>
Front safety device	<b>1074472</b>
Rear safety device	<b>1074473</b>
Protection for lead screws with bellows	<b>1074474</b>
Hydraulic power pack 3.5 l for specimen grips	<b>1074010</b>
Hydraulic power pack 9.8 l for specimen grips	<b>1015075</b>

## Product Information

### Materials Testing Machine 330 kN Z330RED with testControl II

#### Technical data

Item No.	1067947	
<b>Load frame</b>		
Test load $F_N$ in tensile/compression directions	330	kN
Number of guide columns	4	
Number of lead screws	2	
Stiffness of load frame at $H_2 = 1000$ mm	488	kN/mm
Height $H_1$ <sup>1)</sup>	2734	mm
Width $B_1$ <sup>2)</sup>	1420	mm
Depth $T_1$	1032	mm
Base height $H_4$	415	mm
Test area width $B_2$ <sup>3)</sup>	626	mm
Test area height $H_2$	1635	mm
Test stroke $H_3$ (with hydraulic grips)	905	mm
Weight without accessories	2180	kg
With hydraulic grips	2545	kg
Specific floor load (with hydraulic grips)	5.4	kg/cm <sup>2</sup>
Noise level at maximum test speed	<70	dB(A)
<b>Drive</b>		
Crosshead speed	0.00005...400	mm/min
Increased crosshead return speed (at reduced force)	520	mm/min
Travel resolution of drive	0.00015058	µm

1) Incl. substructure

2) Incl. electronics

3) Incl. lead screw protection